

**List of spare parts**

Double seat valve  
Type D 365it-rinsable  
DN 6"

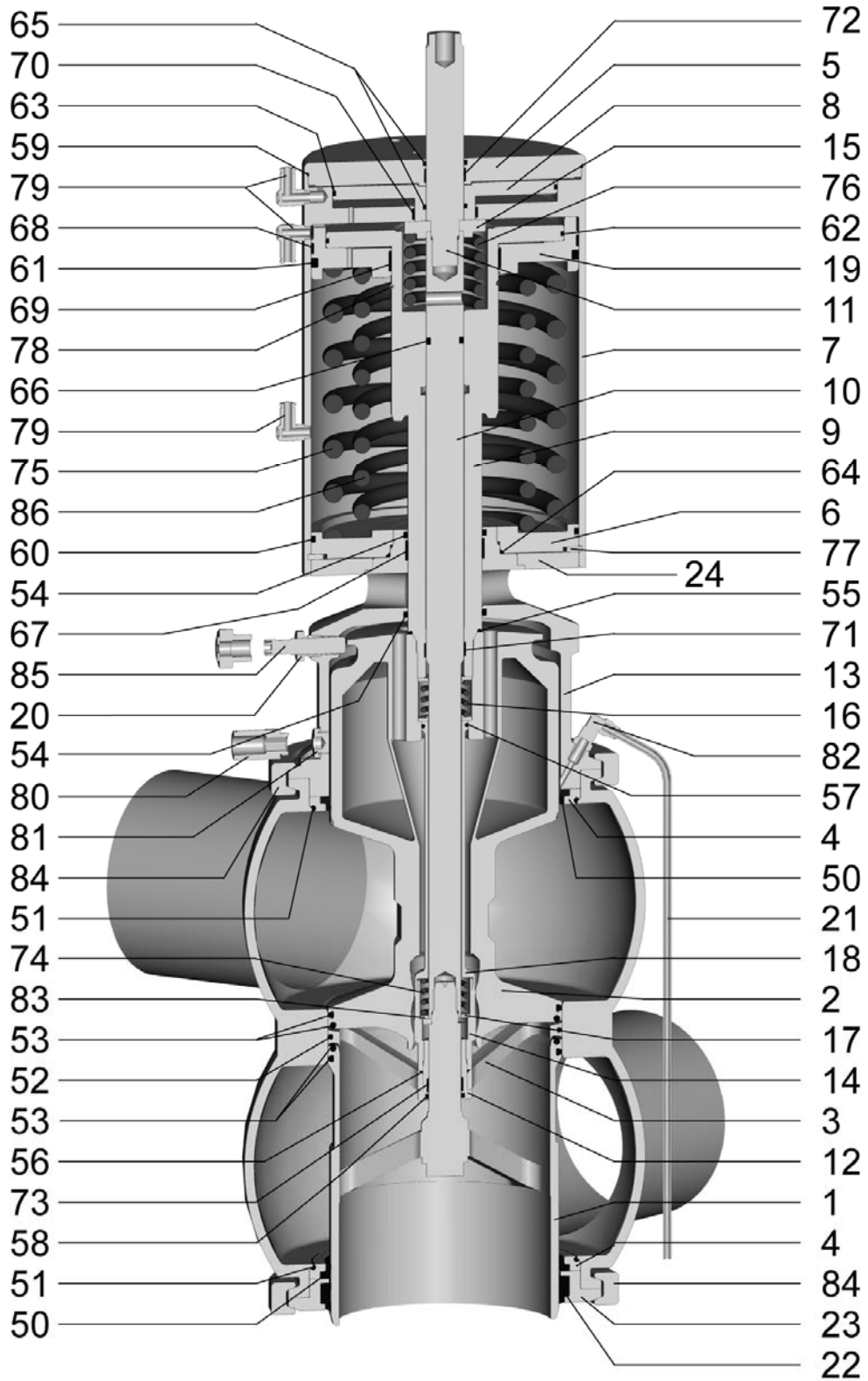

Änderung	Datum	Name	Änderung	Datum	Name	Änderung	Datum	Name	Änderung	Datum	Name

Pos.	Stck.	Benennung	Werkstoff	Best.-Nr.
1	1	Valve disc <sup>1)</sup>	1.4404	2143399
2	1	Closing sleeve <sup>1)</sup>	1.4404	2143494
3	1	Deflector <sup>1)</sup>	1.4404	2143362
4	2	Housing cover base <sup>1)</sup>	1.4404	2143401
5	1	Cylinder cover	1.4301	2143422
6	1	Cylinder plate	1.4301	2143499
7	1	Cylinder	1.4301	2143421
8	1	Stroke piston	1.4301	2143423
9	1	Stroke piston	1.4301	2143498
10	1	Spindle base	1.4301	2143500
11	1	Spindle top	1.4301	2143424
12	1	Screw	1.4404	2143404
13	1	Snaphead support	1.4301	2143495
14	1	Bolt	PEEK	2143405
15	1	Disc	1.4301	2143409
16	1	Spring paket		2156596
17	1	Disc	1.4301	2143407
18	1	Tube	1.4404	2143496
19	1	Piston	1.4301	2143426
20	1	Compression piece	1.4301	2143506
21	1	Tube	1.4301	2143501
22	1	Guide ring *	PTFE	2143402
23	1	Housing cover top	1.4301	2143363
24	1	Loose flange- Snaphead support	1.4301	2132371
	1	Compl. set of gaskets product side consist. of: *	EPDM	2344118
			HNBR	
	1	Compl. set of gaskets actuator side consist. of: #		2344114

**Order example**

1 Profile packing pos. 50, order no. 2143347 as per list E D 365it-sp.39

<sup>1)</sup> When ordering please indicate surface finishes which do not correspond to our standard, i.e.  $R_A \leq 0,8 \mu m$ .

Änderung	Datum	Name	Änderung	Datum	Name	Änderung	Datum	Name	Änderung	Datum	Name

**List of spare parts**

Double seat valve  
Type D 365it-rinsable  
DN 6"

Pos.	Stck.	Benennung	Werkstoff	Best.-Nr.
50	2	Profile packing *	EPDM	2143347
			HNBR	
51	2	O-ring *	EPDM	2154866
			HNBR	
52	1	O-ring *	EPDM	2143349
			HNBR	
53	4	O-ring *	EPDM	2143348
			HNBR	
54	2	O-ring *#	EPDM	2143502
			HNBR	
55	1	O-ring *	EPDM	0995787
			HNBR	
56	1	O-ring *	EPDM	2109413
			HNBR	
57	1	O-ring *	EPDM	2106890
			HNBR	
58	1	O-ring *	EPDM	0970178
			HNBR	
59	1	O-ring #	EPDM	2132110
60	1	O-ring #	NBR	0467316
61	1	O-ring #	NBR	0350017
62	1	O-ring #	NBR	2103103
63	1	O-ring #	NBR	0743112
64	1	O-ring *	NBR	0116046
65	2	O-ring #	NBR	0940437
66	1	O-ring #	NBR	2142206
67	1	Piston guide strip *	PTFE	2143504
68	1	Piston guide strip #	PTFE	0757476
69	1	Piston guide strip #	PTFE	2143431
70	1	Piston guide strip #	PTFE	0399568
71	1	Slide bearing #	PEEK	2154618
72	1	Slide bearing #	PEEK	2154618
73	1	Slide bearing *	PEEK	2155541

DN 6"

Änderung	Datum	Name	Änderung	Datum	Name	Änderung	Datum	Name	Änderung	Datum	Name

**List of spare parts**

Double seat valve  
Type D 365it-rinsable  
DN 6"

Pos.	Stck.	Benennung	Werkstoff	Best.-Nr.
74	1	Compression spring	1.4310	2143429
75	1	Compression spring	CrSi	2143411
76	1	Compression spring	CrSi	2142008
77	1	Guard ring	nickel-plated	0716241
78	1	Snap ring	1.4310	0925115
79	3	Angular screw-in-union		2116513
80	1	Screw-in-union		2143587
81	1	Locking screw		2143586
82	1	Legris angular-union		2143503
83	1	Lock washer	A 2	0926535
84	2	Clamp	1.4308	2142302
85	1	Feedback		2143554
86	1	Compression spring	CrSi	2143412

Änderung	Datum	Name	Änderung	Datum	Name	Änderung	Datum	Name	Änderung	Datum	Name