

# Torque Requirements

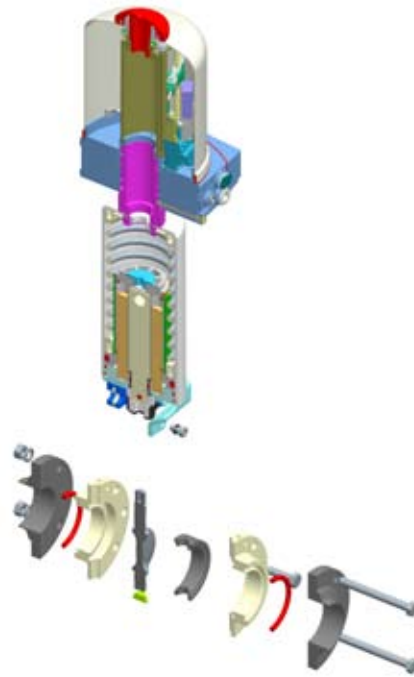

Type	Torque	0.5"	1"	1.5"	2"	2.5"
<b>Standard Butterfly Valves</b>	N·m	5	5	8	10	12
	lb·in	44	44	71	89	106
<b>Mix Proof Butterfly Valves</b>	N·m	10	10	16	20	24
	lb·in	89	89	142	177	212

Type	Torque	3"	4"	5"	6"	8"
<b>Standard Butterfly Valves</b>	N·m	19	22	50	60	80
	lb·in	168	195	443	531	708
<b>Mix Proof Butterfly Valves</b>	N·m	38	44	100	120	160
	lb·in	336	389	885	1062	1416



Südmo North America, Inc.  
 1330 Anvil Drive, Rockford, IL 61115 USA  
 T 815.639.0322 • F 815.639.1135  
 E info@sudmona.com • I www.sudmona.com

Südmo North America, Inc. reserves the right to make changes in the technical specifications at any time.

Revision Date: October 2008

## Butterfly Valves