

Butterfly & Ball Valve ID Key



1 Valve Type	2 Seal Material	3 Port Size	4 Control Options	5 Options	6 Actuator
K582Z	E	20	I2D21X	RS	AS

1. Valve Type	Butt Weld	<i>Manual</i>	Butterfly	K582Z
			Ball	H582
		<i>Pneumatic</i>	Butterfly	K662Z
			Ball	H662
	Tri-Clamp	<i>Manual</i>	Butterfly	K588Z
			Mix Proof Butterfly	L588Z
			Ball	H588
		<i>Pneumatic</i>	Butterfly	K668Z
			Mix Proof Butterfly	L668Z
			Ball	H668
	Small-Flange	<i>Manual</i>	Butterfly	K587Z
			Mix Proof Butterfly	L587Z
Ball			H587	
<i>Pneumatic</i>		Butterfly	K667Z	
		Mix Proof Butterfly	L667Z	
		Ball	H667	

2. Seal Material	E	EPDM (standard)
	V	VMQ (silicone)
	H	HNBR
	F	FPM (Viton equivalent)
	T	EPDM with PTFE coating (available in 1.5" to 4" Butterfly Valves only)
	S	Special (please specify)

3. Port Size

OD Tube		Metric		IPS	
05	0.5"	DN15	15mm	12	1.0"
075	0.75"	DN25	25mm	22	2.0"
10	1.0"	DN32	32mm	32	3.0"
15	1.5"	DN40	40mm	42	4.0"
20	2.0"	DN50	50mm	52	5.0"
25	2.5"	DN65	65mm	62	6.0"
30	3.0"	DN80	80mm		
40	4.0"	DN100	100mm		
60	6.0"	DN150	150mm		

Butterfly & Ball Valve ID Key

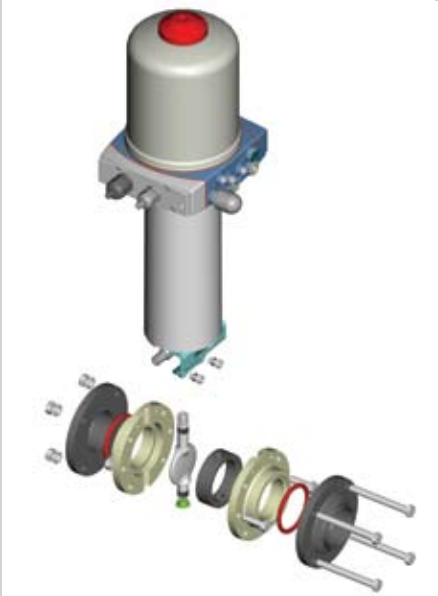

1	2	3	4	5	6
Valve Type	Seal Material	Port size	Control options	Options	Actuator
K582Z	E	20	I2D21X	RS	AS

Valve Specs

Materials

- Product contact: 316L (1.4404)
- Non-product contact: 304 (1.4301)
- Optional: Upon request

Control Air Pressure

- 87 psi min.
- 115 psi max.

Surface Finish

- Ra ≤ 32 µin product contact
- Ra ≤ 63 µin non-product contact

Südmo North America, Inc.

1330 Anvil Drive, Rockford, IL 61115 USA

T 815.639.0322 • F 815.639.1135

E info@sudmona.com • I www.sudmona.com

4. Control Options

Example **a** **b** **c** **d**
 I2 **D** **21** **X**

Note: If the control top option is selected for Butterfly Valves in this section, then the RS (rising stem) option must be selected in the next section under Options (Section 5).

- a) **I2** IntelliTop™ 2.0 Control Top Type 8681
- S** Special (please specify)
- E2** External switches with bracket mount-2 wire (in place of control top)
- E3** External switches with bracket mount-3 wire (in place of control top)
- NOTE: Standard External Prox is 24VDC 12mm tubular, 3 wire, 4 pin - **E3D10Q**
- XX** No feedback

- b) **A** 110 VAC
- D** 24 VDC

- c) **10** 1 prox, 0 solenoid (external only)
- 20** 2 prox, 0 solenoid
- 21** 2 prox, 1 solenoid
- 21A** 2 prox, 1 solenoid w/ASI Bus
- 21D** 2 prox, 1 solenoid w/DeviceNet™

- d) **X** PG-9 connection (standard for 110V and 24V control tops)
- Q** Quick disconnect option (standard for ASI and DeviceNet™ tops)

5. Options

Note: If you selected the control top for a Butterfly Valve in step 4 above, you must select the RS (rising stem) option in this section. The rising stem is required to mount a control top to a Butterfly Valve. It is not required for mounting external proximity switches.

- XX** Standard handle
- PB** Handle with prox switch
- RS** Rising stem
- LH** Lock-out handle with mechanical stop

6. Actuator

- AS** Air to open, spring to close
- SA** Spring to open, air to close
- AA** Air to open, air to close

Südmo North America, Inc. reserves the right to make changes in the technical specifications at any time.